

PRODUCT CODE 3058

## TruGrip Masking Tapes

Asian Paints TruGrip Masking Tapes are designed to be used in a wide range of painting, brushing and spraying applications. They are suitable for masking of variety of substrates and for wood work.

Asian Paints TruGrip Masking Tapes help you achieve the right finish for your surfaces.



### PRODUCT BENEFITS

- **Single solution to both painters & carpenters**
- **Optimum combination of peel strength and sheer strength**
- **No paint seepage, no residue on substrate upon removal**



\* All Asian Paints products contain no added Lead, Mercury, Arsenic or Chromium from April 2008.

### PRODUCT FEATURES

#### PRODUCT APPEARANCE

**OPAQUE**

#### SETTING TIME



### RECOMMENDED USAGE



**CARPENTRY**  
Various wood substrates



**STENCIL**



**PAINTING**

### FOR PAINTING

#### PRE-APPLICATION STEPS

**ROUGHEN, DRY AND CLEAN SURFACES TO BE BONDED**



Clean and dry surface where the tape has to be used

#### APPLICATION PROCESS

**STEP 1**

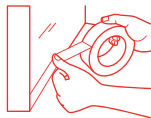

Apply the tape on the edges of the surface to be painted so that the tape acts as a border for the surface.

**STEP 2**

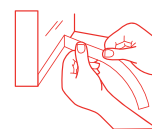

After painting, gently remove the tape and dispose.

### FOR CARPENTRY

#### PRE-APPLICATION STEPS

**ROUGHEN, DRY AND CLEAN SURFACES TO BE BONDED**



Clean and dry surface where the tape has to be used

#### APPLICATION PROCESS

**STEP 1**



Apply the adhesive on the surfaces to be held together.

**STEP 2**



Once stuck together, secure both the substrates with masking tape. Optionally, place a heavy object on the surface.

**STEP 3**

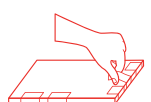

After drying, gently remove the tape and dispose.

## ADDITIONAL INFORMATION

### SAFETY FEATURES

---

- Store the product in a cool and dry place.
- Keep out of reach of children and away from eatables.
- May be harmful if swallowed. In case of ingestion seek immediate medical attention.
- Do not pour leftover tapes down the drain or in water courses.

### TECHNICAL DETAILS

---

- Form: XXX
- Storage Temperature: 18 deg. C to 25 deg. C